



THERM-A-SMOKE

Cold smoke seal for use with fire resisting door assemblies

INTRODUCTION

THERM-A-SMOKE is a high density ambient temperature pile seal which has a polypropylene fin for improved smoke control at ambient temperatures. The pile is contained in a PVC casing.

APPLICATION

THERM-A-SMOKE is designed to provide cold smoke control in the early stages of a fire, it is primarily used in conjunction with an intumescent fire seal that is concealed behind the door lipping.

It is recommended that THERM-A-SMOKE is rebated into the door frame. Once the intumescent fire seal has activated, the smoke seal has completed its function.

THERM-A-SMOKE can also be used in refurbishment projects.

In daily life, THERM-A-SMOKE functions as a draught and weather seal, controlling air flow and reducing noise.

AVAILABILITY

THERM-A-SMOKE is supplied as standard in brown, white, black and cream casings.

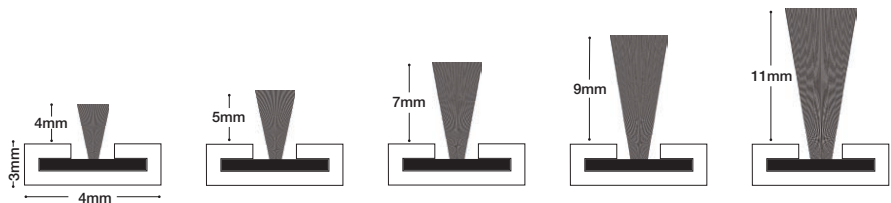
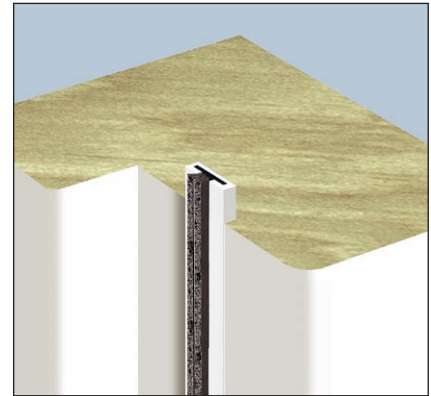
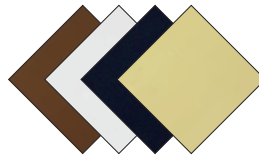

* Colours may vary slightly between examples illustrated in print, online and actual samples - which will depend upon lighting conditions in situ.